

A1

No.	REVISIONS	DATE	DRAWN	APP.
△				
△				

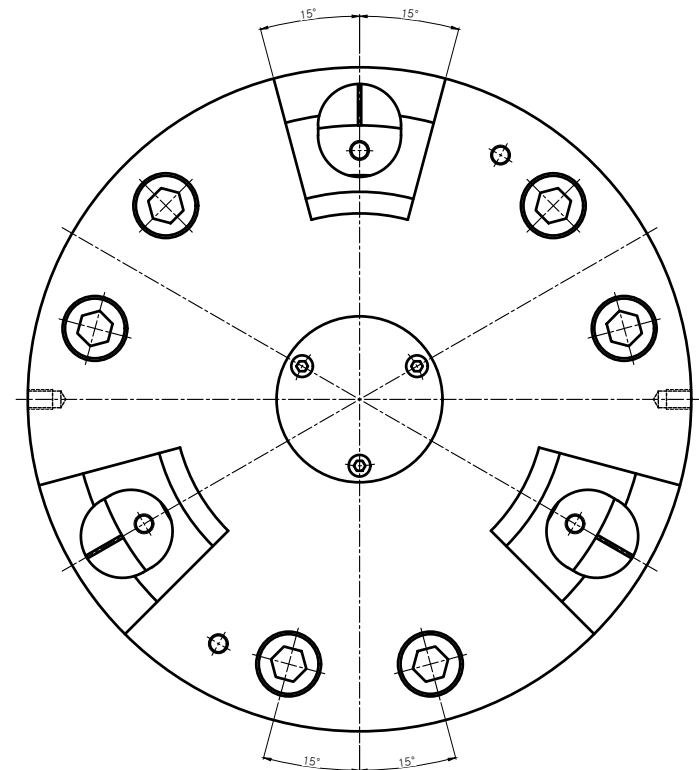
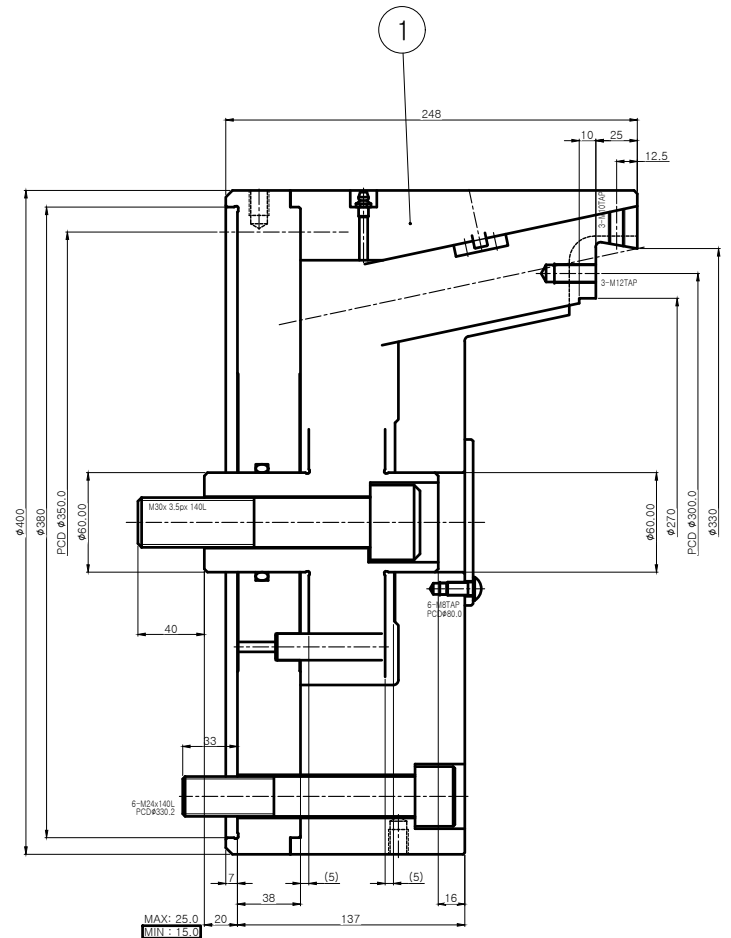

CHUCK SPEC.			
CHUCK SPEC.	POL-300		
PLUNGER STROKE	10 mm		
JAW STROKE	φ4.2 mm		
MAX. INPUT FORCE	4,000 kgf		
CLAMPING FORCE	7,520 kgf		
MAX. SPEED	2,000 rpm		
MOMENT OF INERTIAL	5.6 kgf.m²	표준 파악	STANDARD TOP JAW
WEIGHT	165 kg	범위 (mm)	- 150~270

1	BLANK CHUCK	STD.	POL-300	1SET	-
NO.	TITLE OF ITEM	MATERIAL	SIZE & SPEC.	QTY	NOTE
	TITLE	PIN ARBOR CHUCK (POL-300)	PART NAME	ASSEMBLY DRAWING	
DWG. NO.	POL-300-00		AGENCY		
CODE NO.	-		USER		
			DATE		
SCALE	1 : 1	Approved	Checked	Designed	