

No.	REVISIONS	DATE	DRAWN	APP.
①				
②				

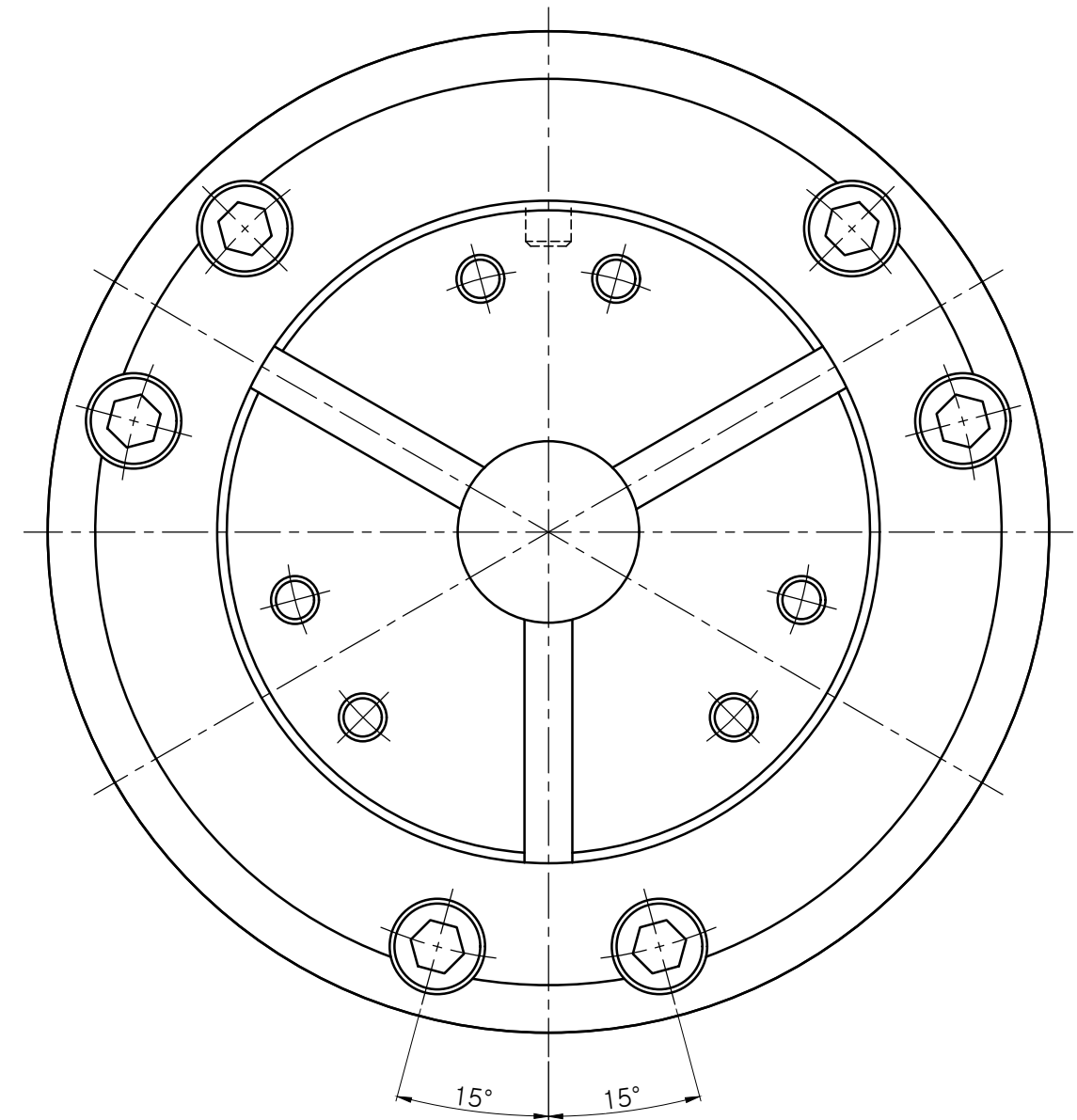
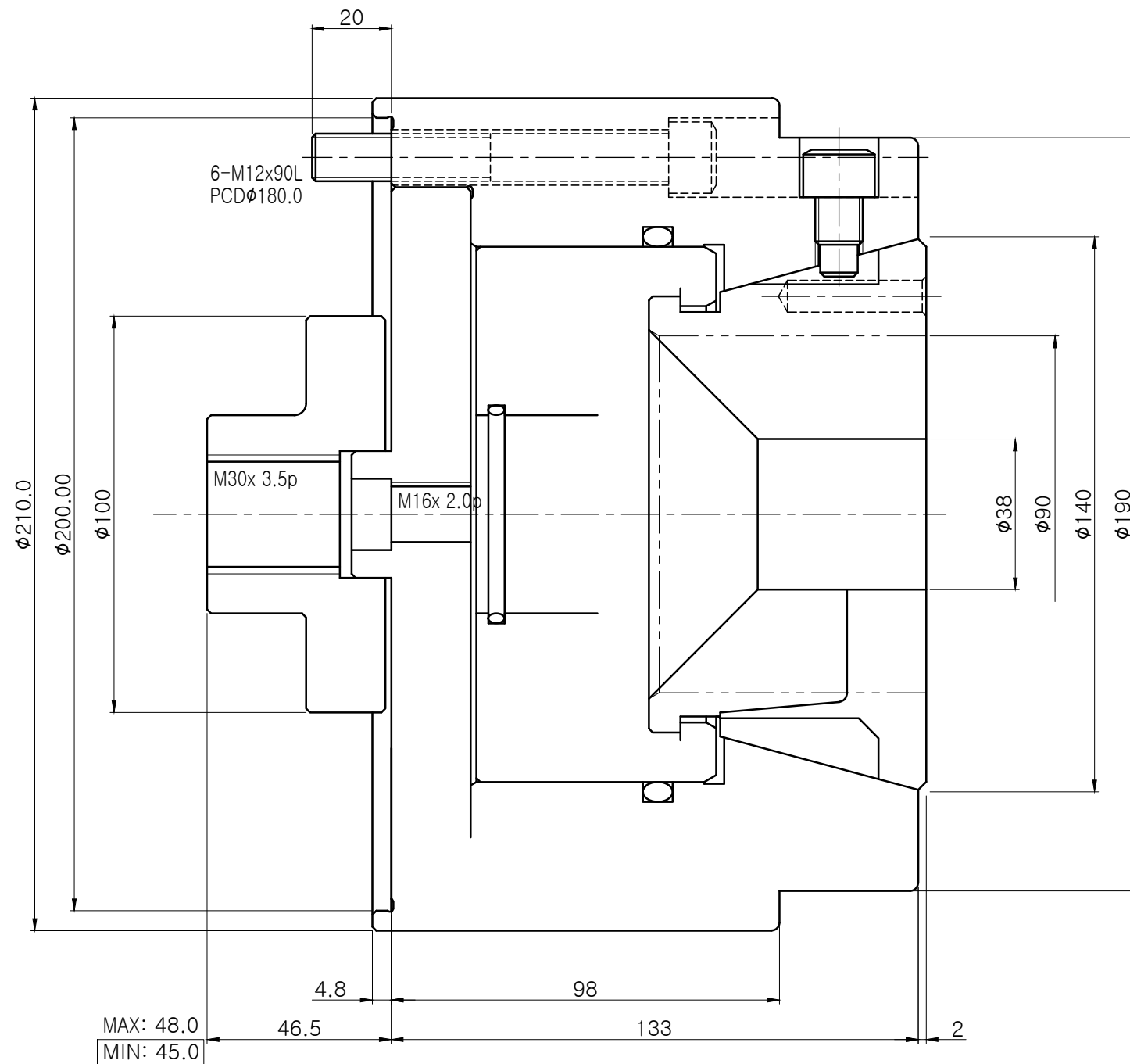

CHUCK SPEC.	
CHUCK SPEC.	COR-90B
PLUNGER STROKE	3.5 mm
JAW STROKE	φ1 mm
MAX. INPUT FORCE	6,500 kgf
CLAMPING FORCE	13,300 kgf
MAX. SPEED	3,500 rpm
MOMENT OF INERTIAL	- kgf.m ²
WEIGHT	38 kg

표준 파악 범위(mm)	φ30 ~ φ90(mm)
--------------	---------------

-	CHANGING FIXTURE	STD.	-	-	주문사양
-	ADAPTER	STD.	-	-	주문사양
-	COLLET	STD.	-	-	주문사양
01	BLANK CHUCK	STD.	COR-90B	1SET	-
NO.	TITLE OF ITEM	MATERIAL	SIZE & SPEC.	Q'TY	NOTE
TITLE	OUTSIDE COLLET CHUCK (COR-90B)		PART NAME	ASSEMBLY DRAWING	
DWG. NO.	COR-90B		AGENCY	-	
CODE NO.	-		USER	-	
			DATE	-	
SCALE	1 : 1		Approved	Checked	Designed



No.	REVISIONS	DATE	DRAWN	APP.
①				
②				

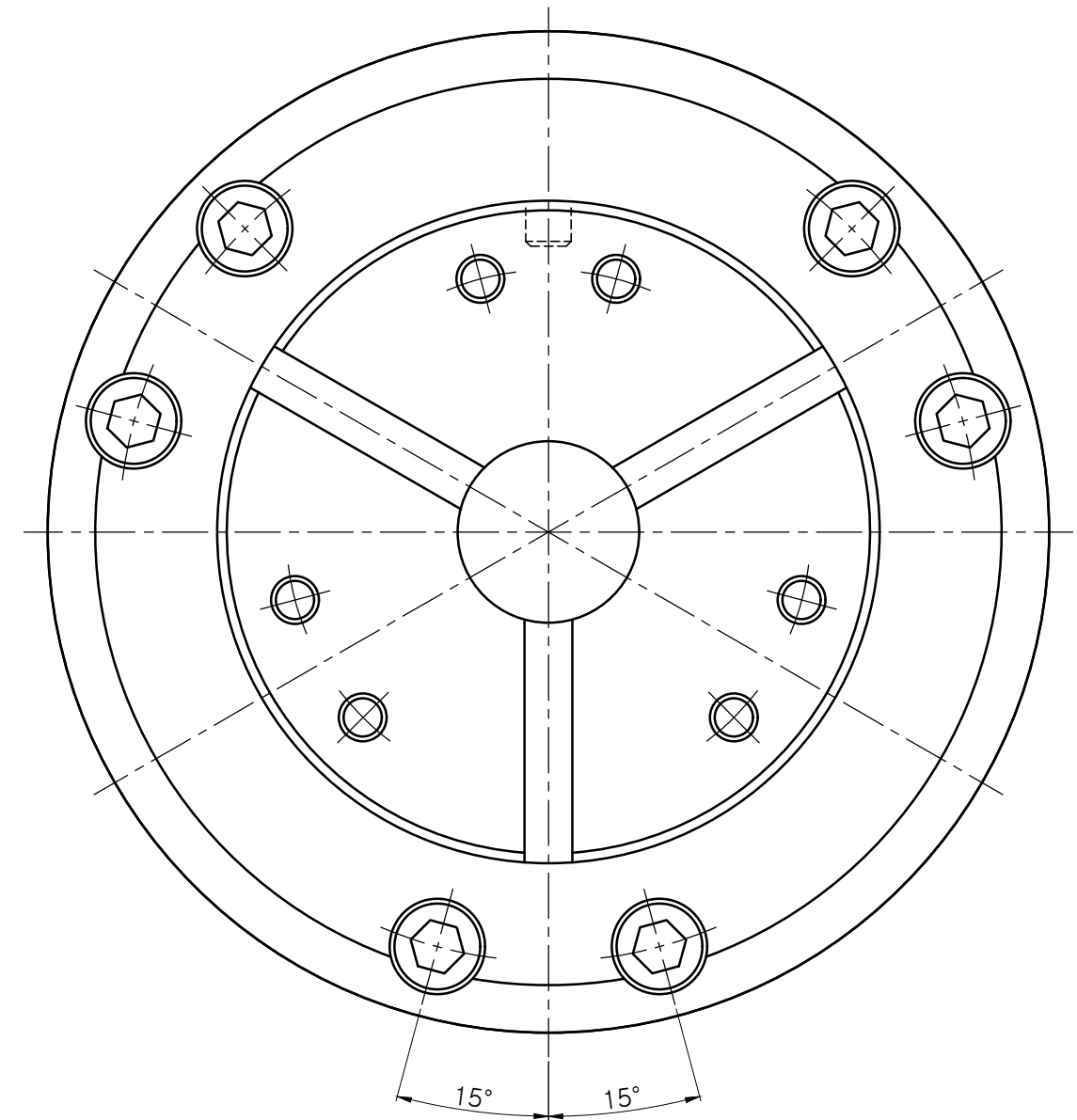
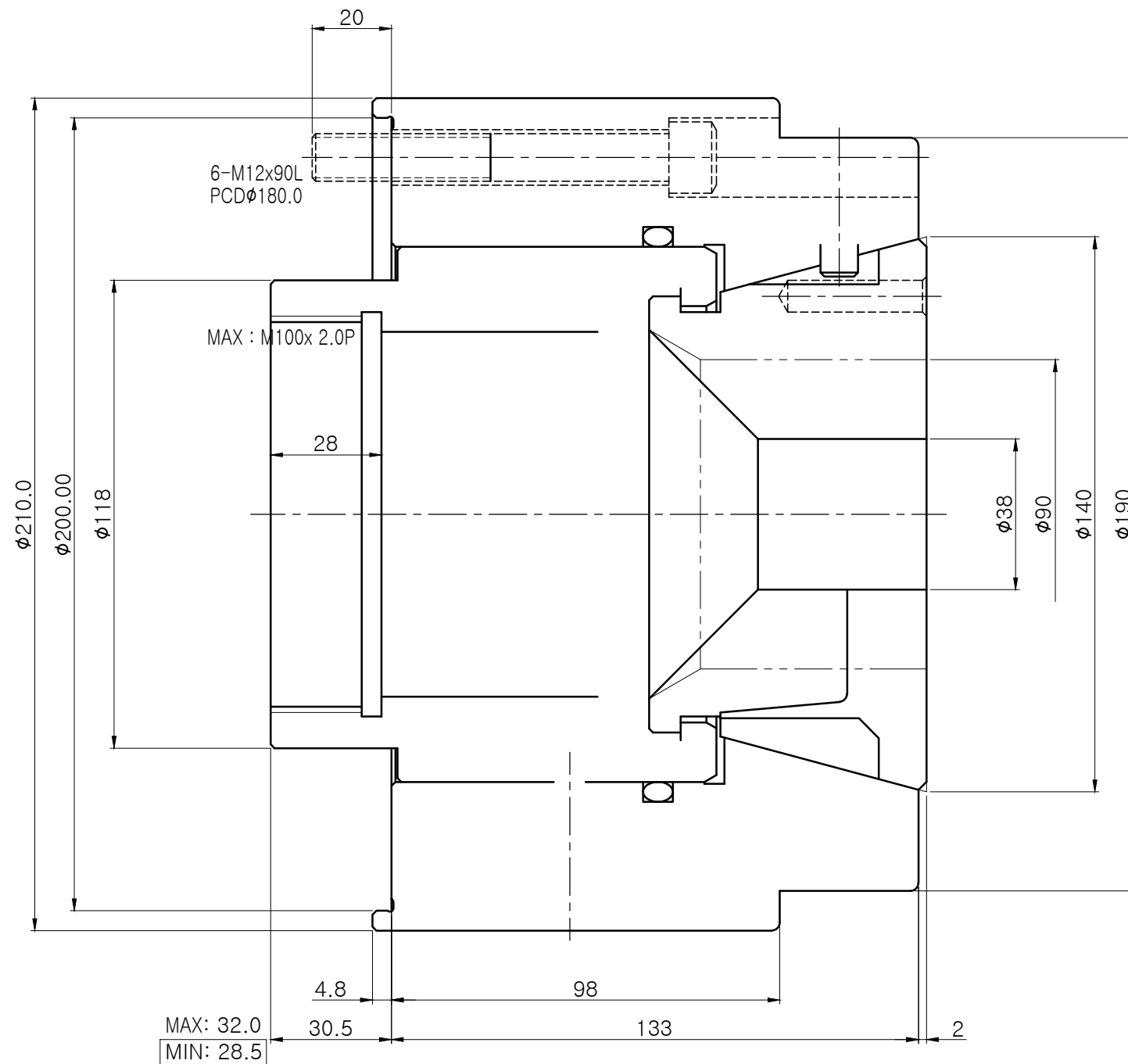

CHUCK SPEC.			
CHUCK SPEC.	COR-90		
PLUNGER STROKE	3.5 mm		
JAW STROKE	φ1 mm		
MAX. INPUT FORCE	6,500 kgf		
CLAMPING FORCE	13,300 kgf		
MAX. SPEED	3,500 rpm		
MOMENT OF INERTIAL	- kgf.m ²	표준 파악	φ30 ~ φ90(mm)
WEIGHT	38 kg	범위(mm)	

-	CHANGING FIXTURE	STD.	-	-	주문사양
-	ADAPTER	STD.	-	-	주문사양
-	COLLET	STD.	-	-	주문사양
01	BLANK CHUCK	STD.	COR-90	1SET	-
NO.	TITLE OF ITEM	MATERIAL	SIZE & SPEC.	Q'TY	NOTE
	TITLE	OUTSIDE COLLET CHUCK (COR-90)		PART NAME	ASSEMBLY DRAWING
	DWG. NO.	COR-90		AGENCY	-
	CODE NO.	-		USER	-
				DATE	-
	SCALE	1 : 1			
		Approved	Checked	Designed	