

No.	REVISIONS	DATE	DRAWN	APP.
1				
2				

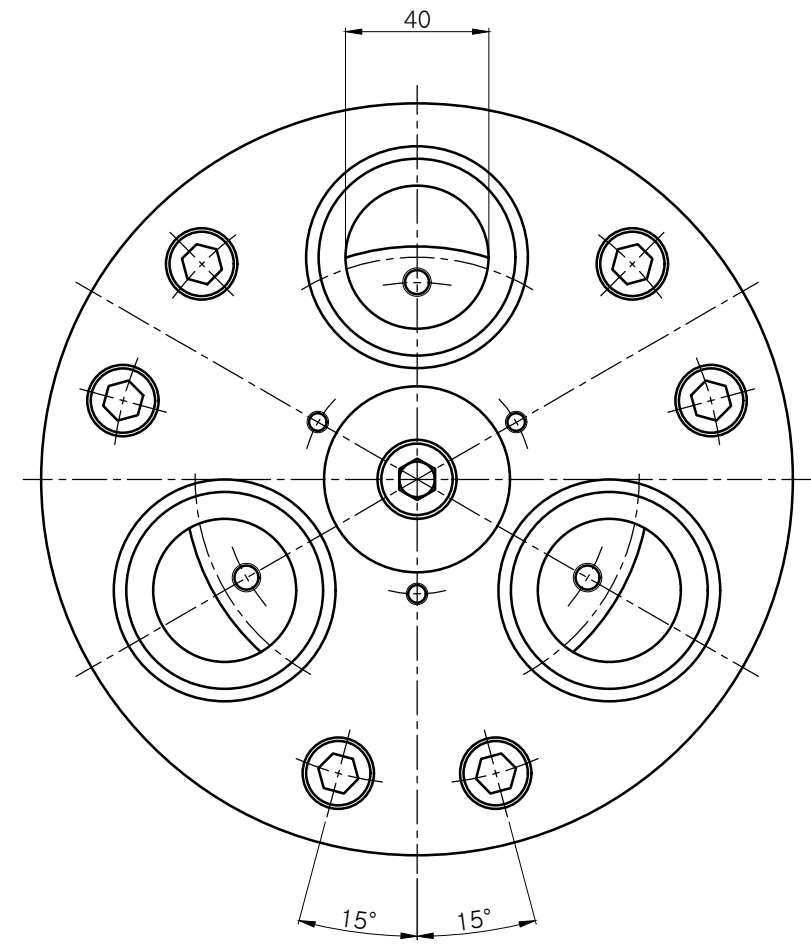
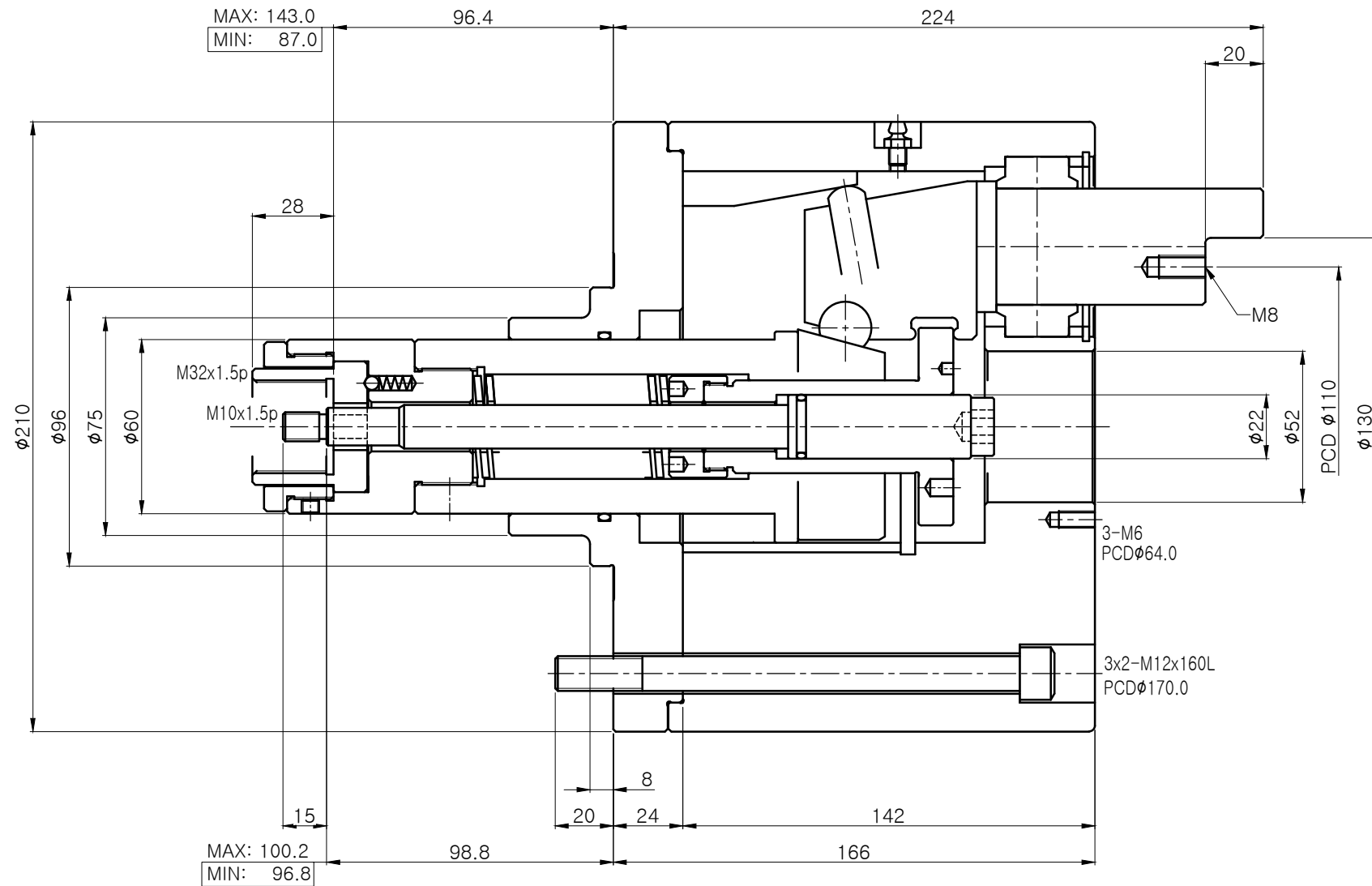

CHUCK SPEC.	
CHUCK SPEC.	RS-200
PLUNGER STROKE	56 mm
JAW STROKE	12 mm
MAX. INPUT FORCE	3,878 kgf
CLAMPING FORCE	6,633 kgf
MAX. SPEED	3,500 rpm
MOMENT OF INERTIAL	. kgf.m <sup>2</sup>
WEIGHT	48 kg

1	BLANK CHUCK	STD.	RS-200	1SET	-
NO.	TITLE OF ITEM	MATERIAL	SIZE & SPEC.	Q'TY	NOTE
TITLE	RETRACTABLE CHUCK (RS-200)	PART NAME	ASSEMBLY DRAWING		
DWG. NO.	RS-200	AGENCY	-		
CODE NO.	-	USER	-		
		DATE	-		
SCALE	1 : 1	Approved	Checked	Designed	