

No.	REVISIONS	DATE	DRAWN	APP.
①				
②				

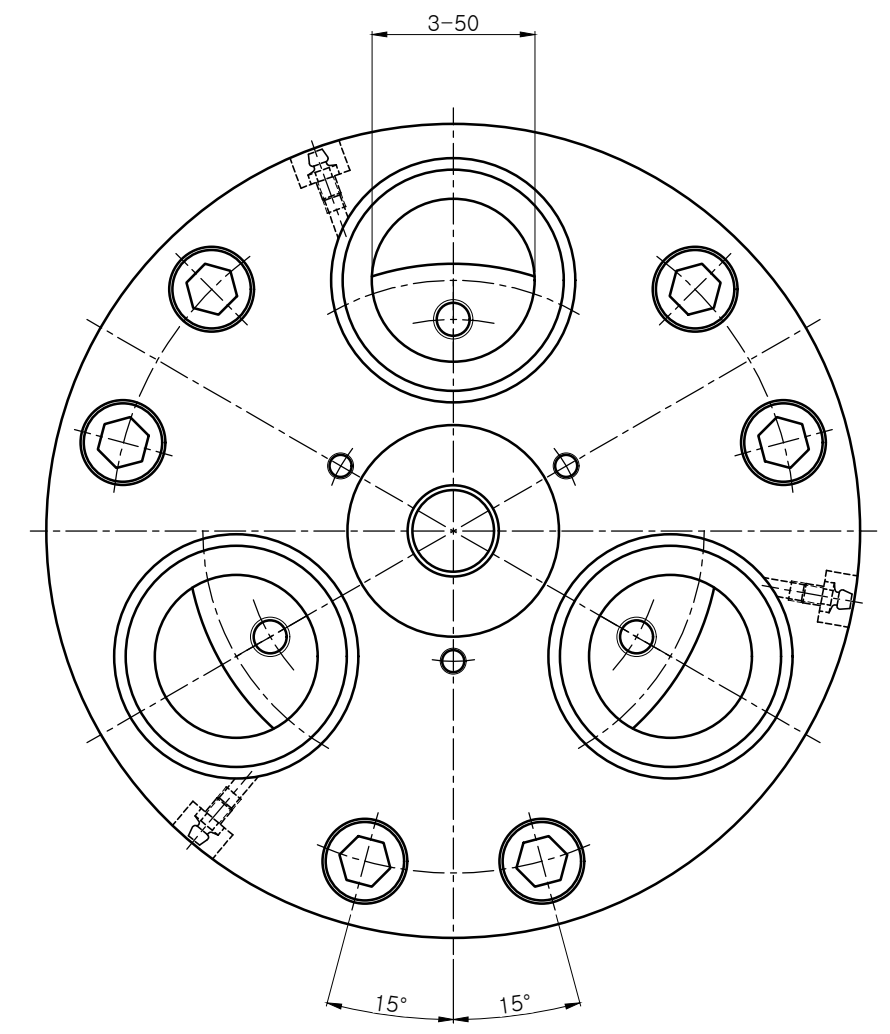
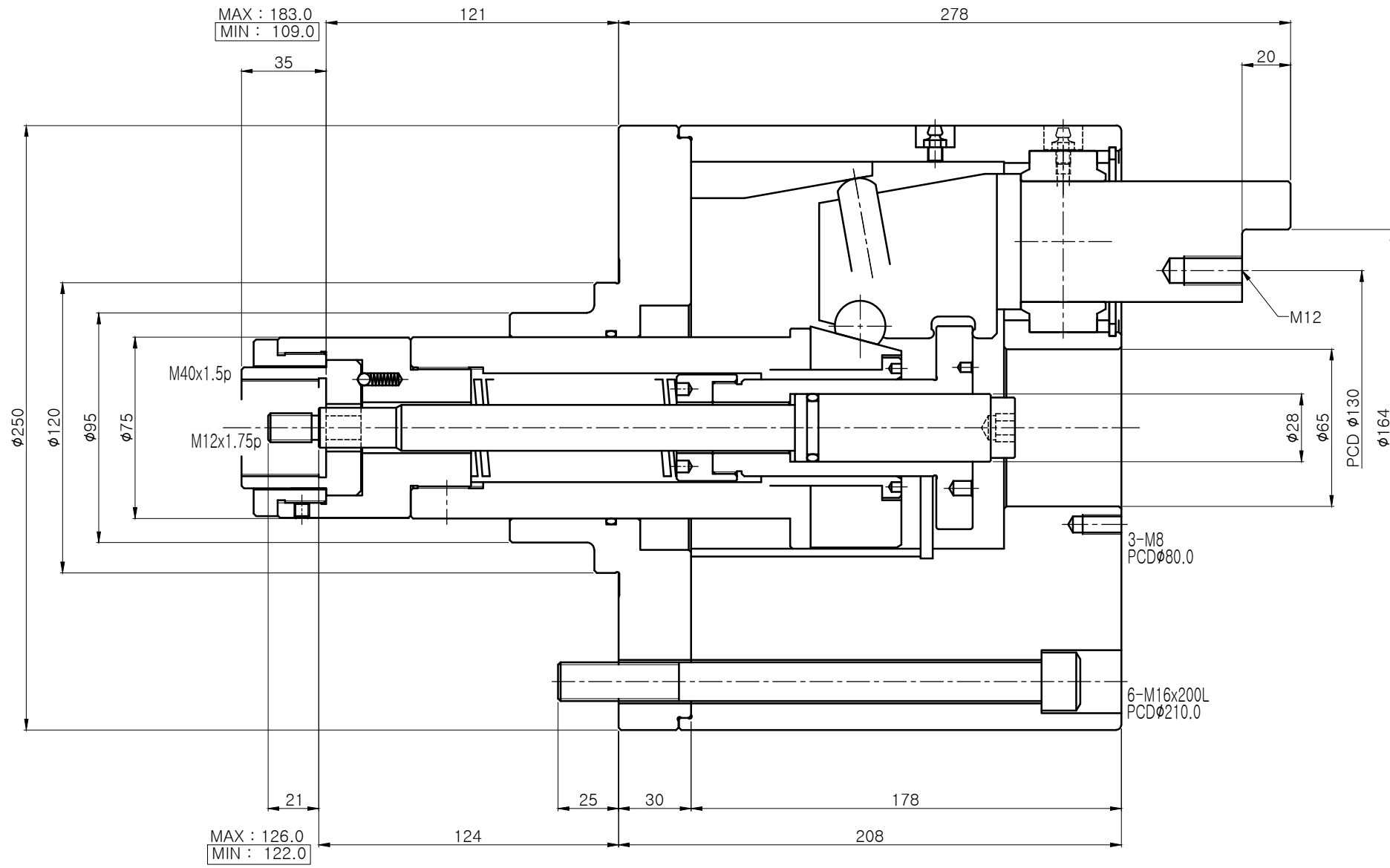

CHUCK SPEC.	
CHUCK SPEC.	RS-250
PLUNGER STROKE	74 mm
JAW STROKE	14.5 mm
MAX. INPUT FORCE	. kgf
CLAMPING FORCE	. kgf
MAX. SPEED	3,500 rpm
MOMENT OF INERTIAL	. kgf.m <sup>2</sup>
WEIGHT	. kg

1	BLANK CHUCK	STD.	RS-250	1SET	-
NO.	TITLE OF ITEM	MATERIAL	SIZE & SPEC.	Q'TY	NOTE
TITLE	RETRACTABLE CHUCK (RS-250)	PART NAME	ASSEMBLY DRAWING		
DWG. NO.	RS-250	AGENCY	-		
CODE NO.	-	USER	-		
		DATE	-		
SCALE	1 : 1	Approved	Checked	Designed	